

NOTES:

1. MATERIAL: ALUMINUM 6061-T6 PER ASTM B221.
2. VIBRO-ETCH PART, WITH DRAWING NUMBER, WITH MIN .12 HIGH CHARACTERS IN ACCORDANCE WITH MIL-STD-130. LOCATE AND ORIENT TEXT APPROXIMATELY AS SHOWN.

REVISION APPROVALS									
REV	ECN NO.	DESCRIPTION	DATE	BY	CHK	DES	ENG	SUPV	
A	-	INITIAL RELEASE	-	-	-	-	-	-	-

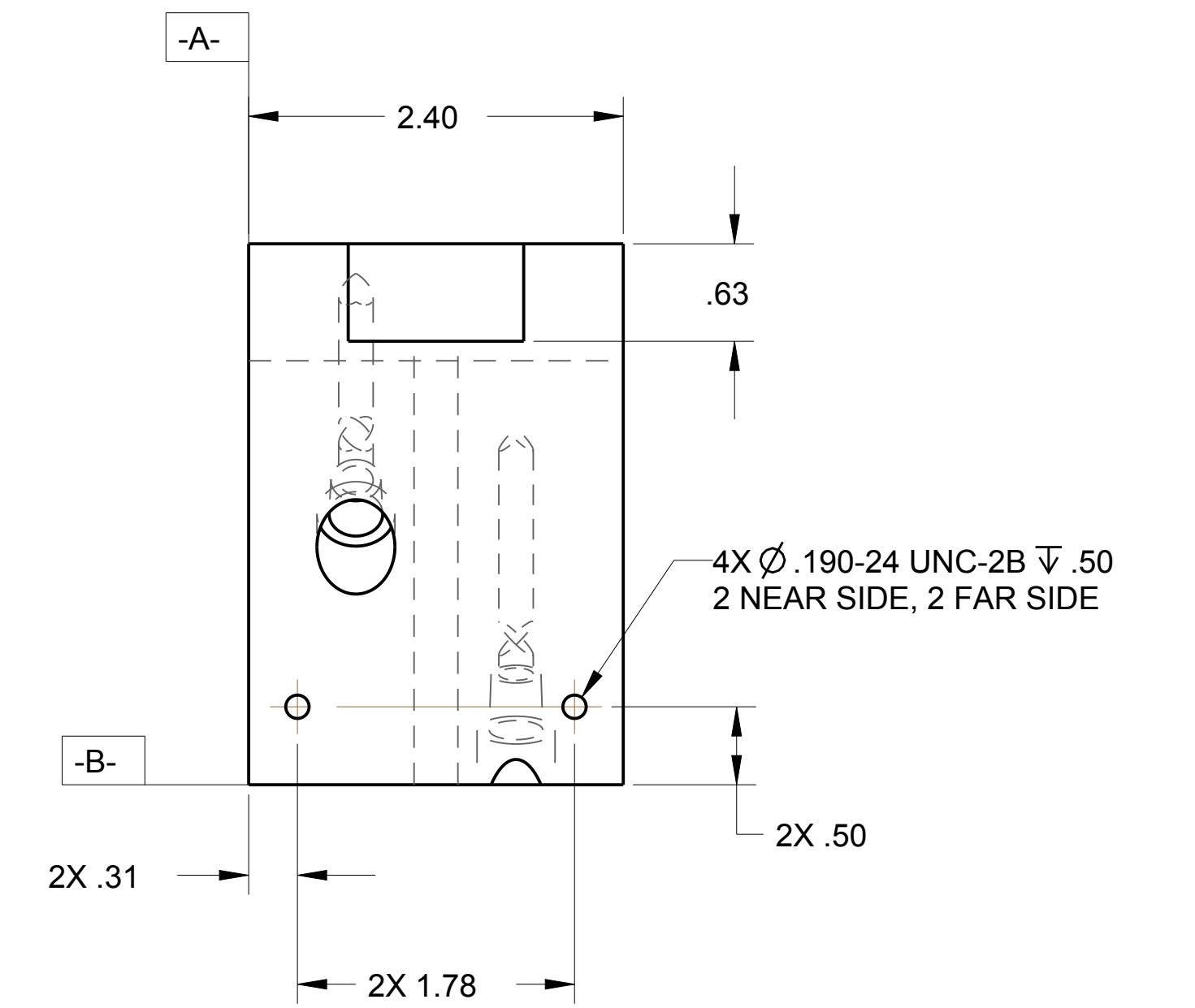
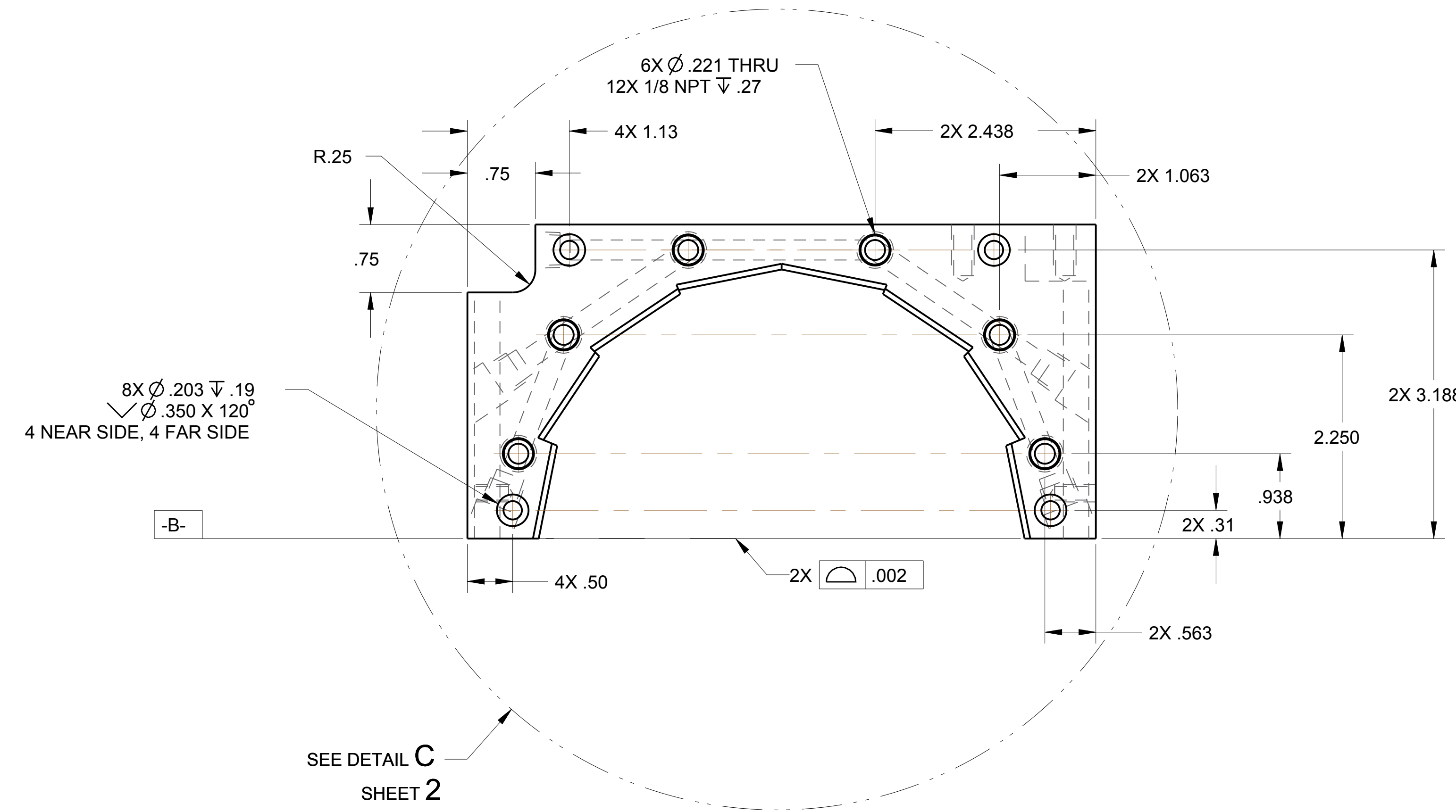
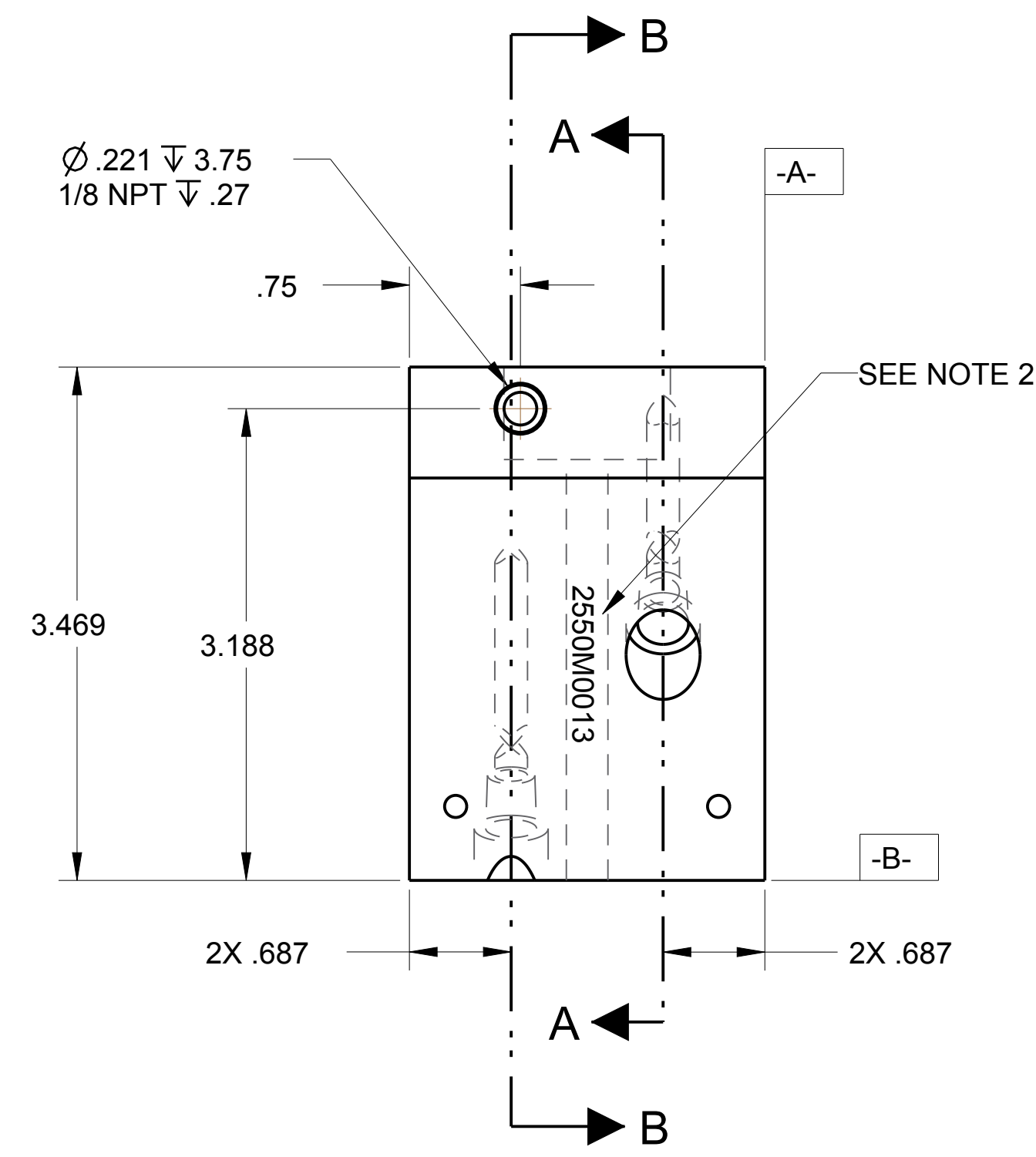
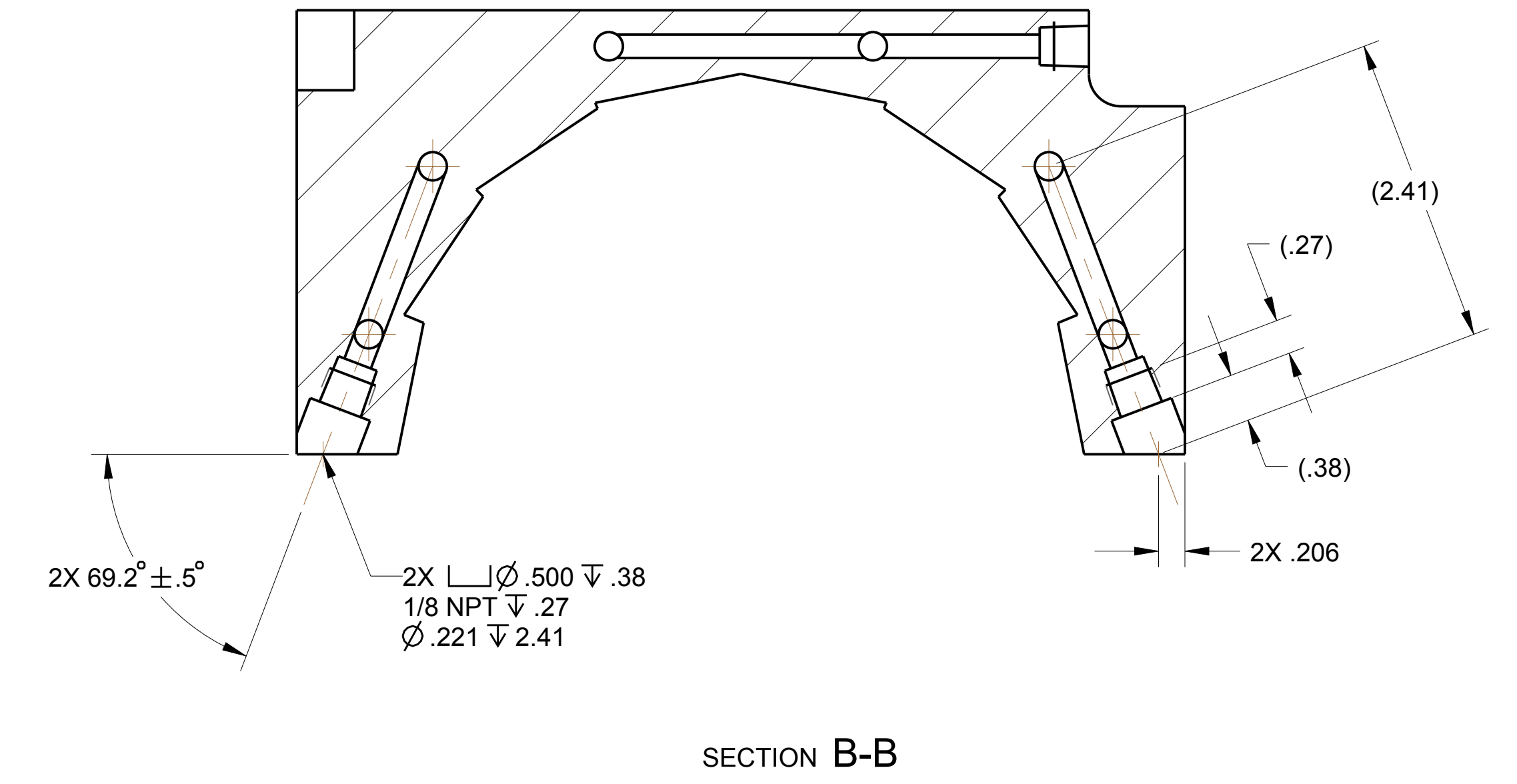
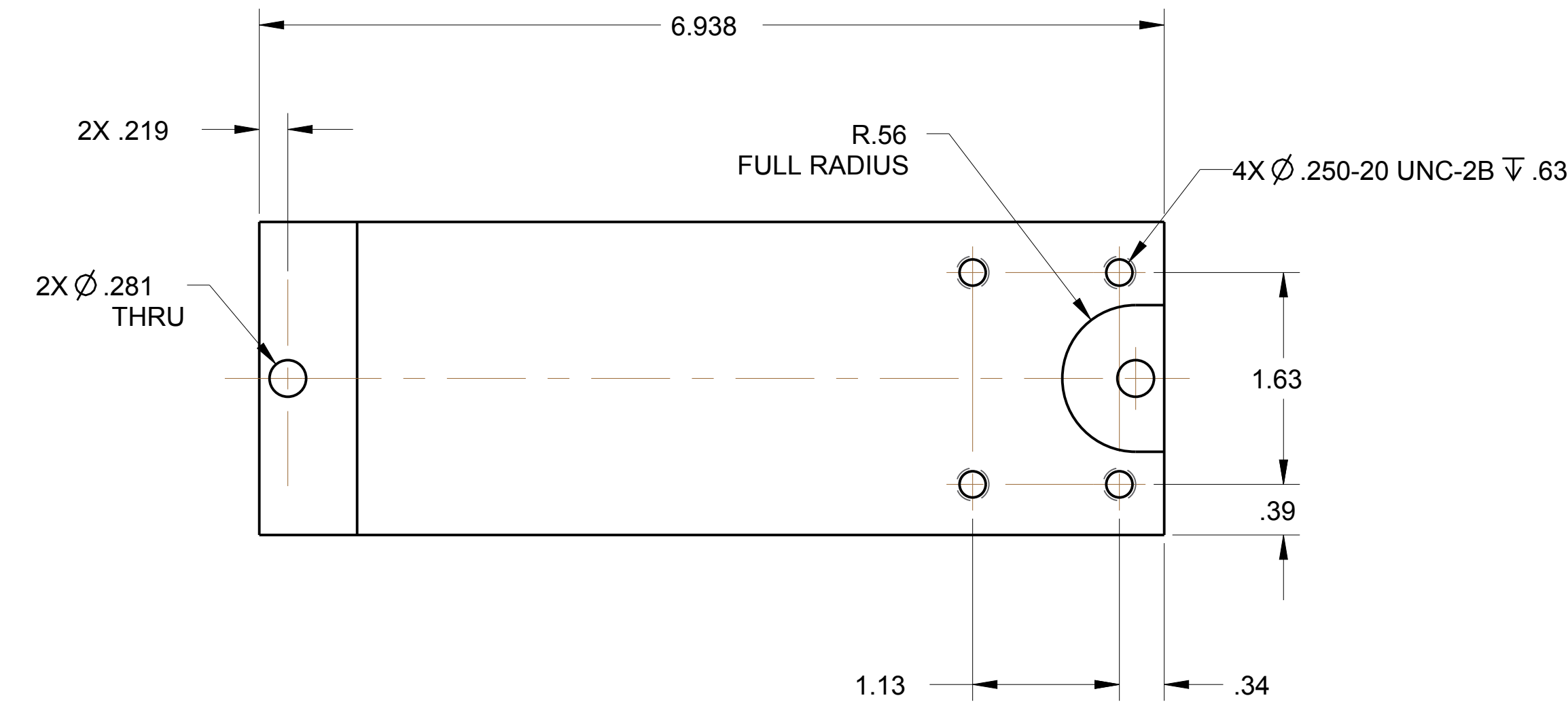
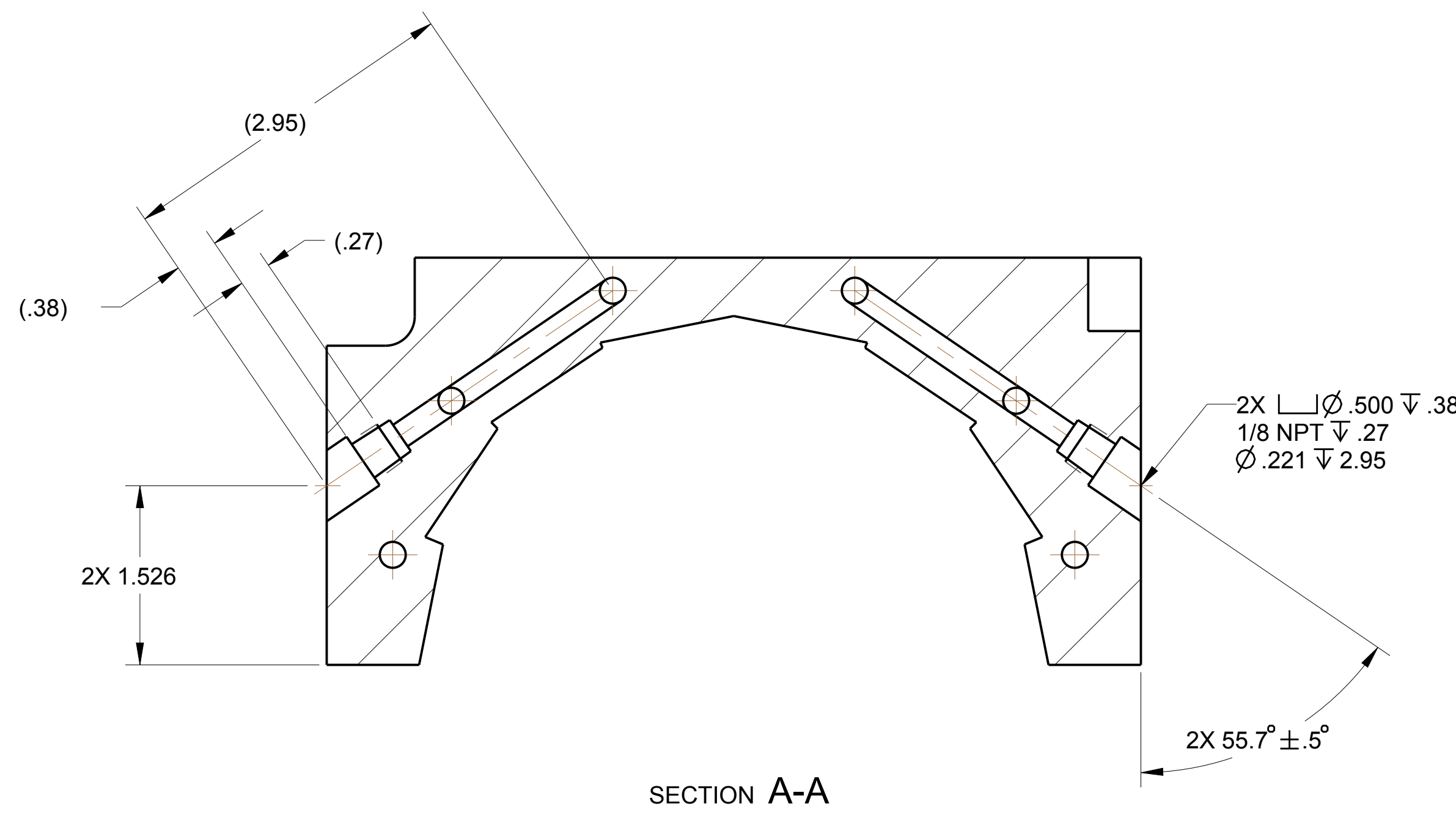

PRELIMINARY

INTERPRET IN GENERAL ACCORDANCE WITH ASME Y14.5			COLLIDER-ACCELERATOR DEPARTMENT BROOKHAVEN NATIONAL LABORATORY UPTON, N.Y. 11973	
UNLESS OTHERWISE SPECIFIED			CBETA HALBACH MAGNETS BDH CORE LEFT	
DIMENSIONS ARE IN INCHES		DRAWN BY: S.STRABOCCHI CHECKED: [Signature] APPROVED: [Signature]	DRAWING NUMBER: 2550M0013 REV. A	
2550M0055	1	DECIMAL TOLERANCES: .XXX: .015 .XXX: .005 ANGULAR TOLERANCE ± 1°	SIZE: E CATEGORY: A3 SCALE: 1/1 WEIGHT: 2.3 SHEET OF 1 2	
2550M0054	1	FINISH: 125 BREAK SHARP EDGES MAX. OBPN: 015 SAFETY/ASC DEPARTMENT CODE	D.A. CATEGORY: A3 SCALE: 1/1 WEIGHT: 2.3 SHEET OF 1 2 CREO	
USED ON DRAWING NO. QTY. PER ASSY.				
APPLICATION				

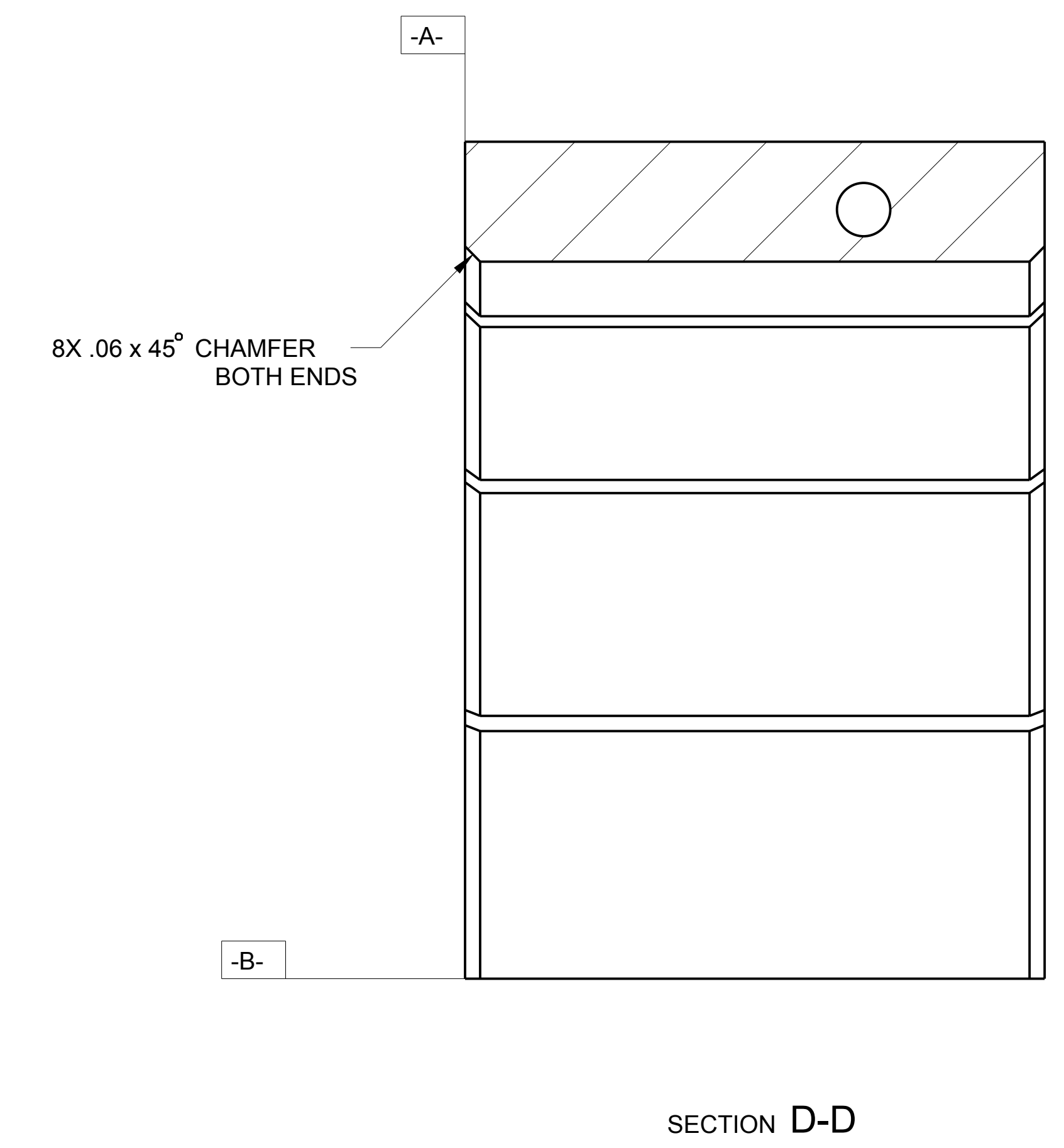
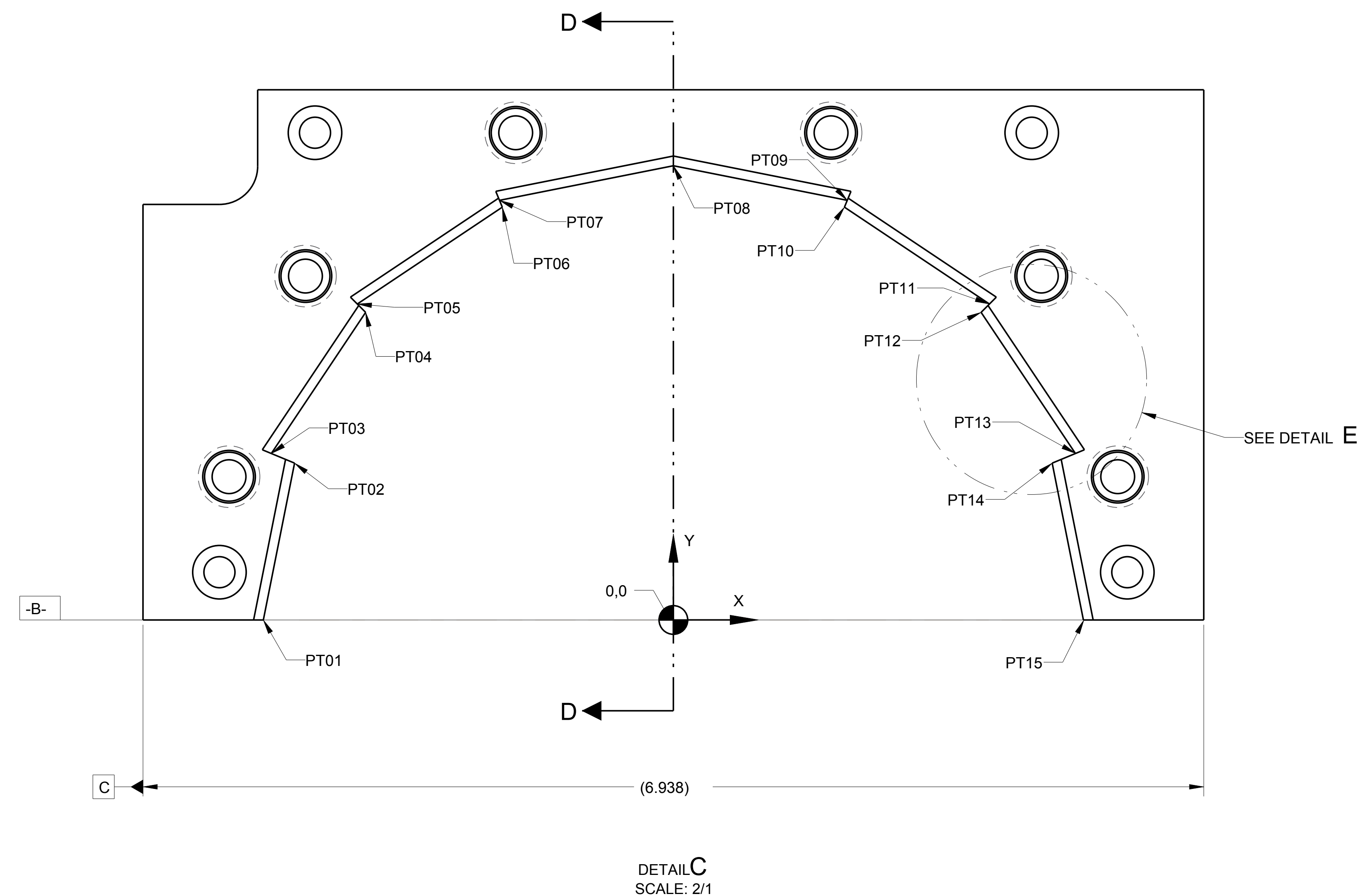

⊕ ∅ .002 A B C

POINT NAME	X	Y
PT01	-2.682	0.000
PT02	-2.477	1.026
PT03	-2.630	1.089
PT04	-2.013	2.013
PT05	-2.067	2.067
PT06	-1.119	2.701
PT07	-1.137	2.745
PT08	0.000	2.972
PT09	1.137	2.745
PT10	1.119	2.701
PT11	2.067	2.067
PT12	2.013	2.013
PT13	2.630	1.089
PT14	2.477	1.026
PT15	2.682	0.000

