

- NOTES:
1. MATERIAL: ALUMINUM 6061-T6 PER ASTM B221.
 2. VIBRO-ETCH PART, WITH DRAWING NUMBER, WITH MIN. .12 HIGH CHARACTERS IN ACCORDANCE WITH MIL-STD-130. LOCATE AND ORIENT TEXT APPROXIMATELY AS SHOWN.

REVISION APPROVALS								
REV	ECN NO.	DESCRIPTION	DATE	BY	CHK	DES	ENG	SUPV
A	-	INITIAL RELEASE	-	-	-	-	-	-

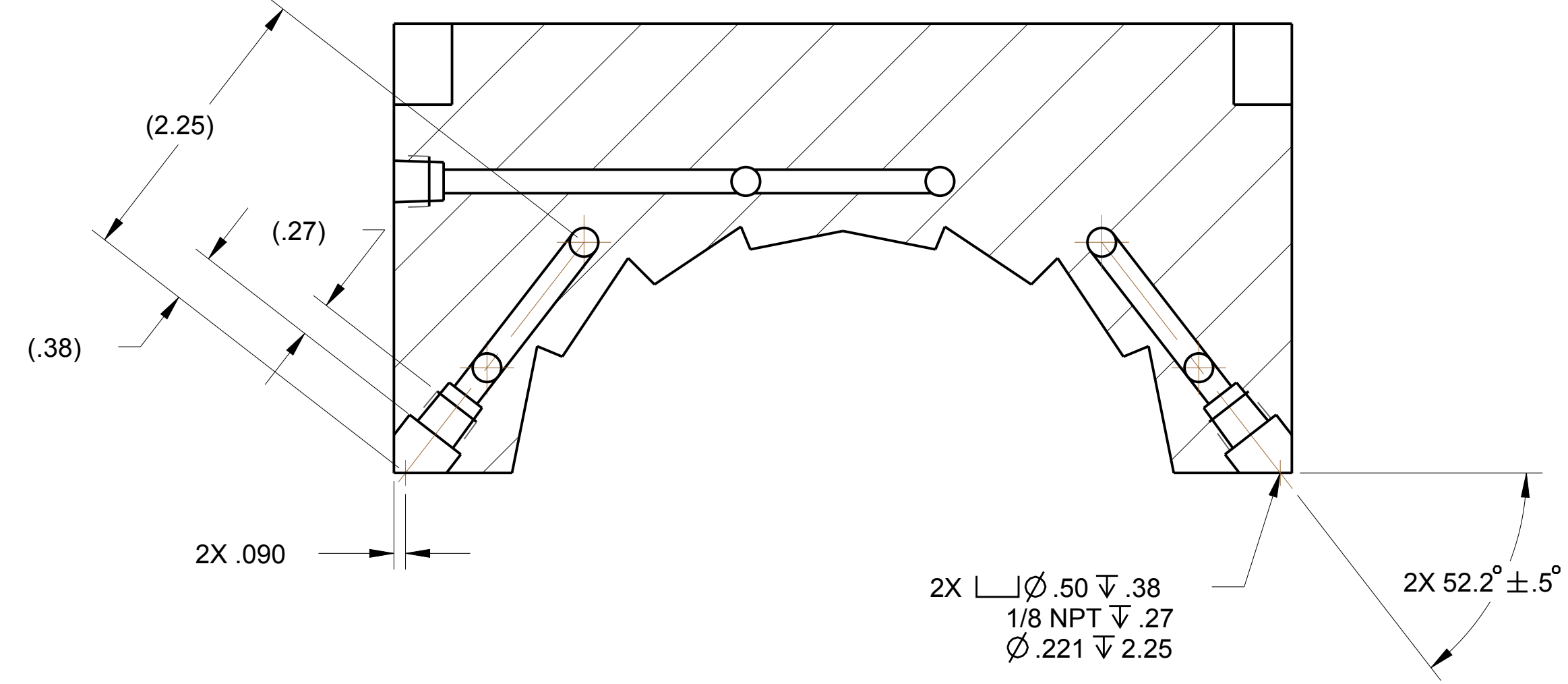

SECTION B-B

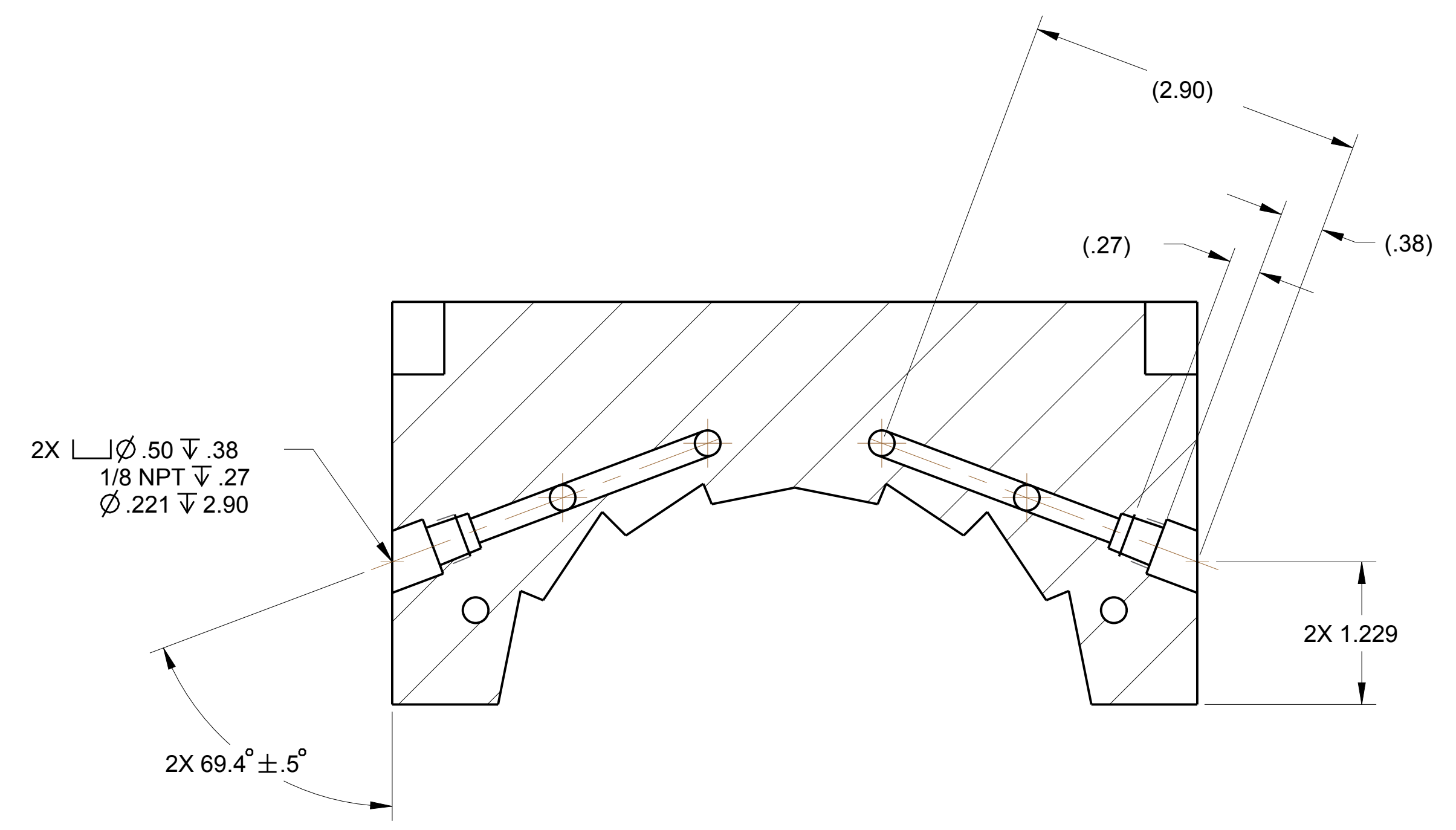
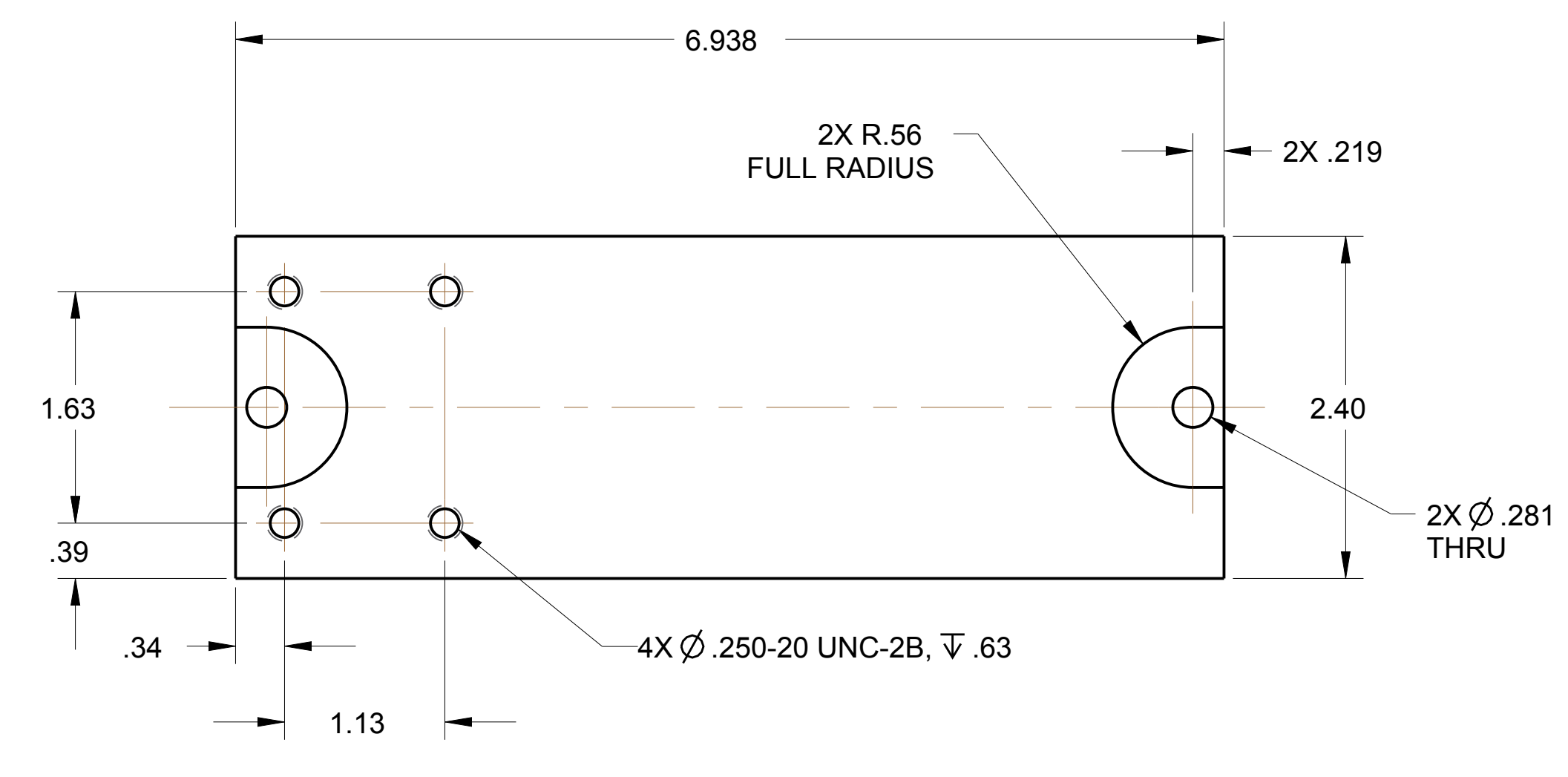

SECTION A-A

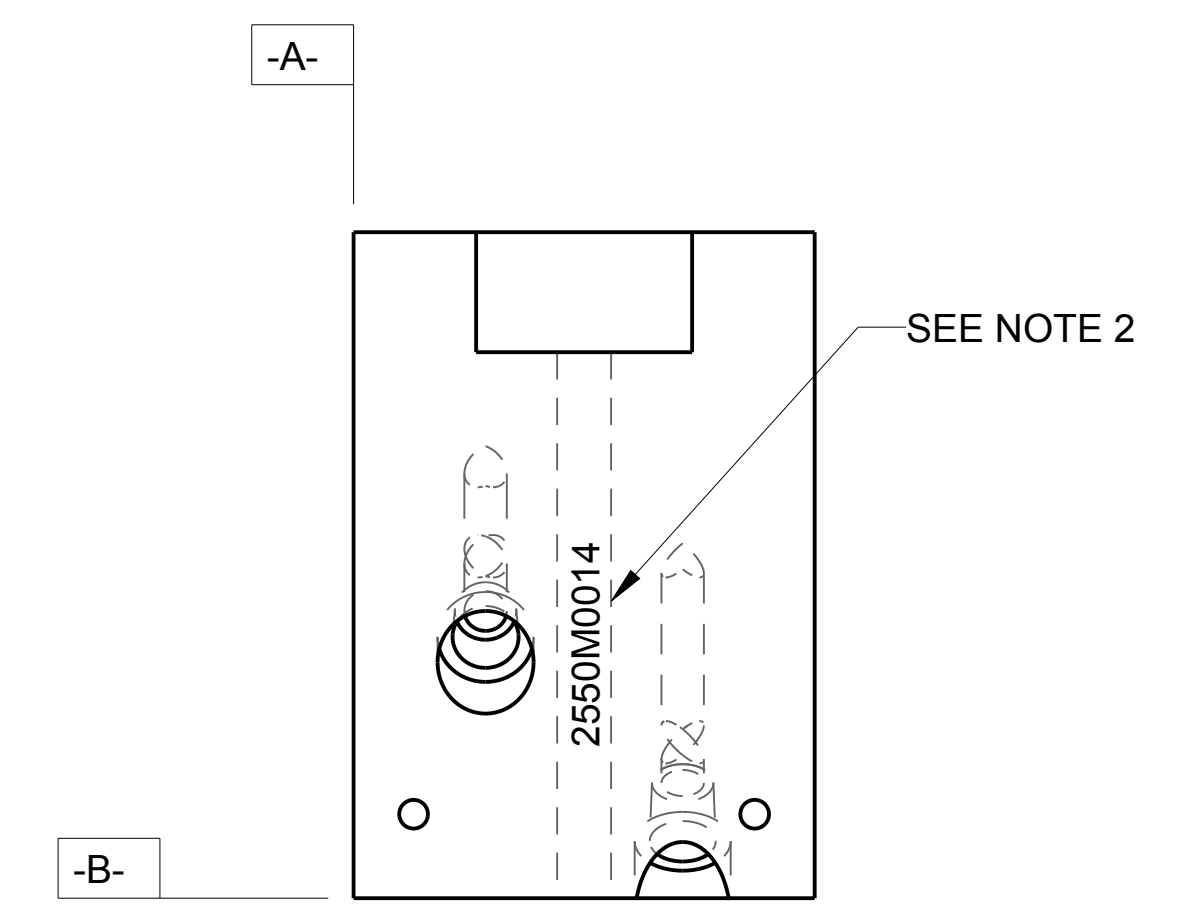
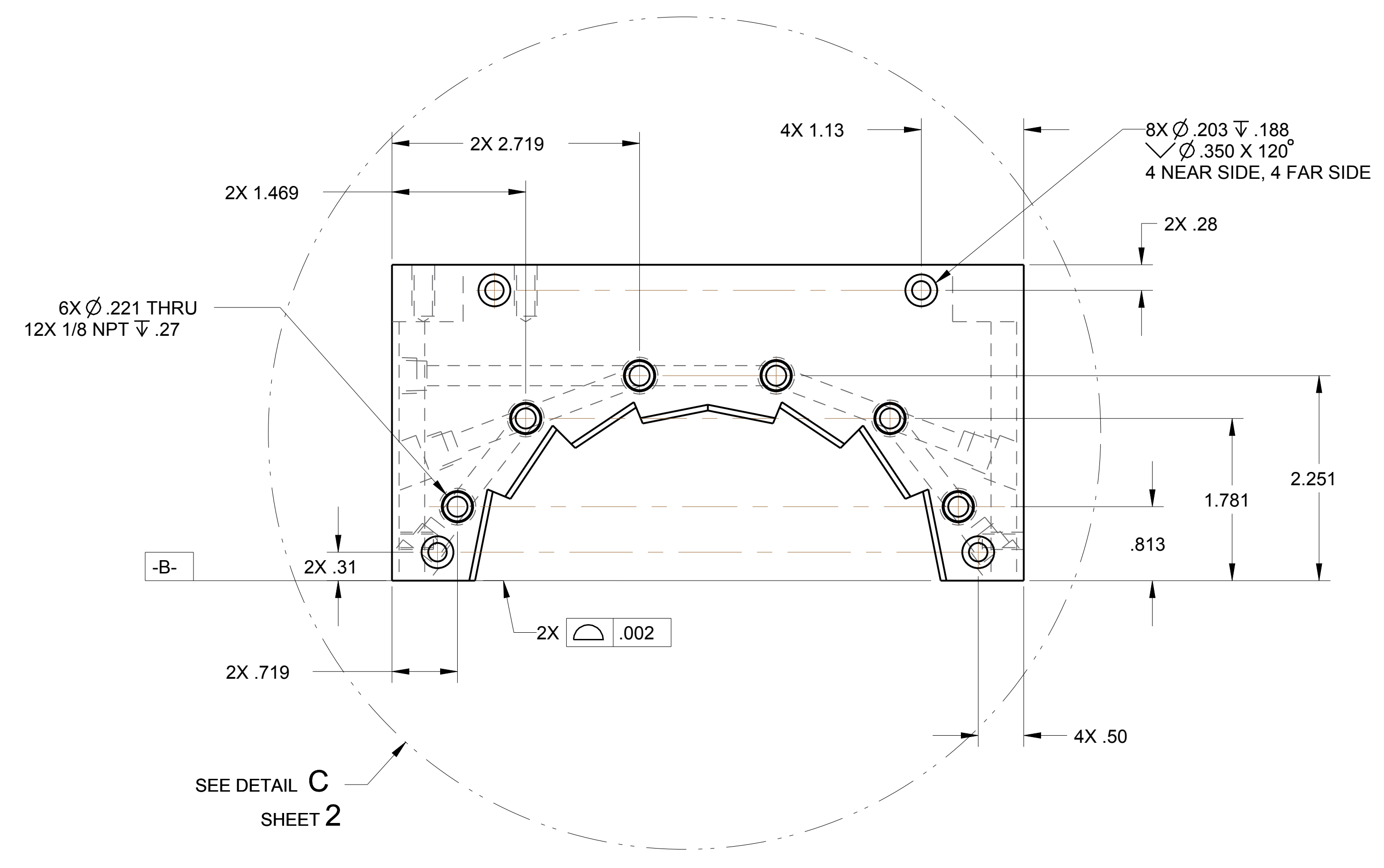
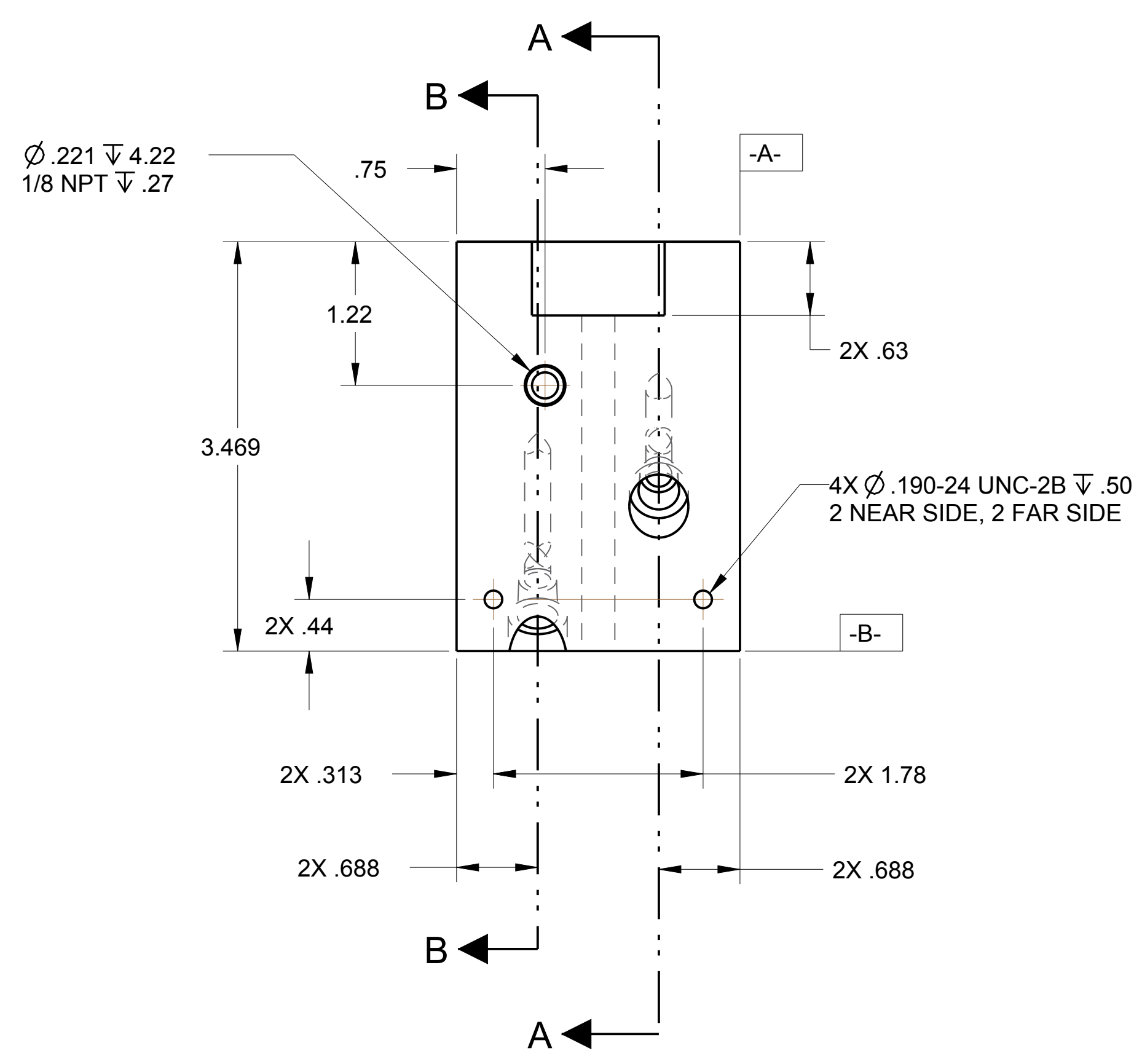

PRELIMINARY

INTERPRET IN GENERAL ACCORDANCE WITH ASME Y14.5		DRAWN BY S.STRABOCCHI 082917		COLLIDER-ACCELERATOR DEPARTMENT BROOKHAVEN NATIONAL LABORATORY UPTON, N.Y. 11973			
UNLESS OTHERWISE SPECIFIED		DIMENSIONS ARE IN INCHES		CBETA HALBACH MAGNETS BDH CORE RIGHT			
DECIMAL TOLERANCES JOB 005 3000 015 3000 005		ANGULAR TOLERANCE ±		DRAWING NUMBER		REV.	
2550M0056 1		125		E		2550M0014 A	
2550M0054 1		BREAK SHARP EDGES		CATEGORY		SCALE: 1/1 WEIGHT: 3.6 SHEET OF 1 2	
USED ON DRAWING NO. QTY. PER ASSY.		FINISH MAX. GRN 015		SAFETY / RSC DEPARTMENT CODE		CREO	

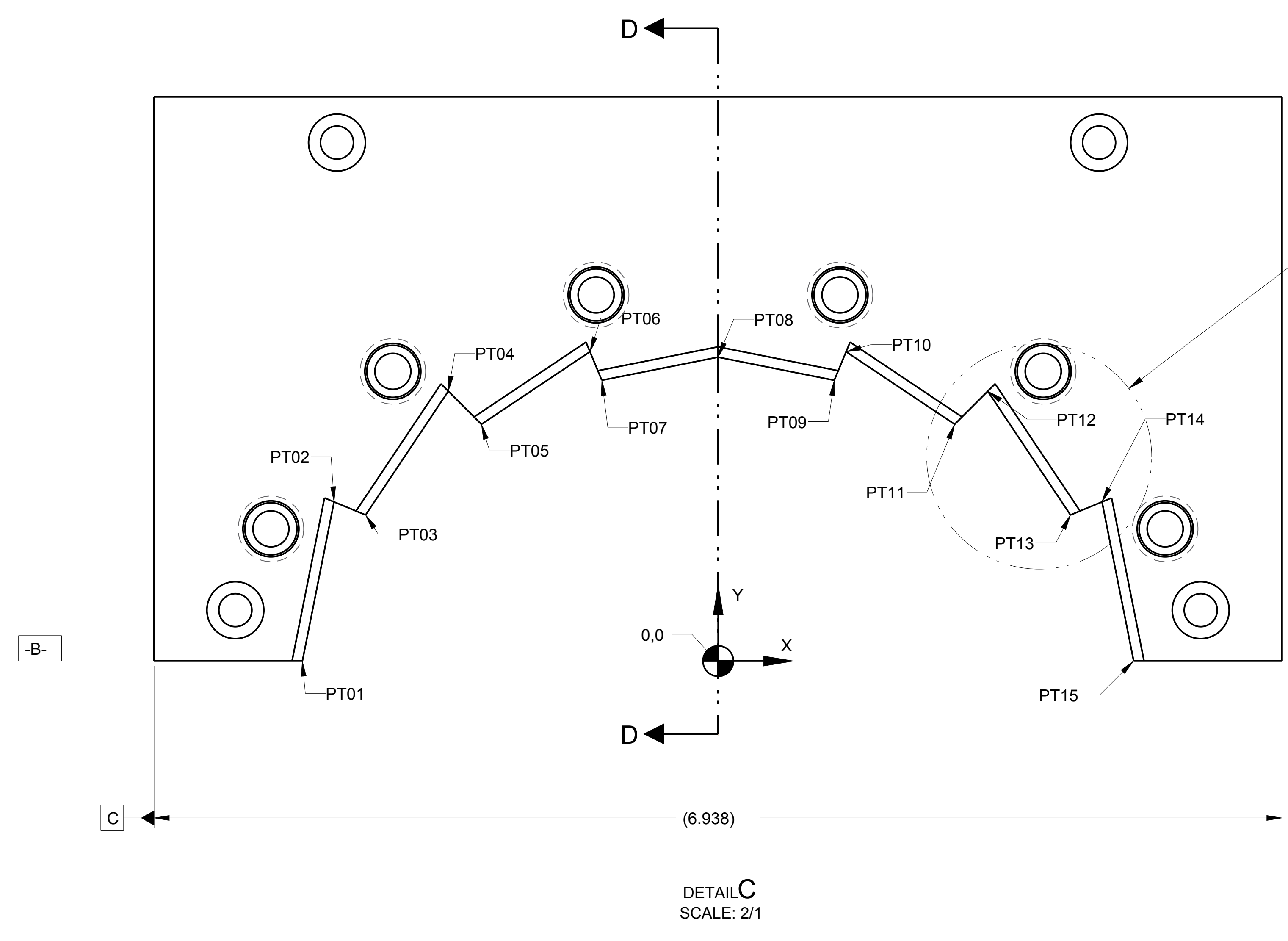

SEE DETAIL E

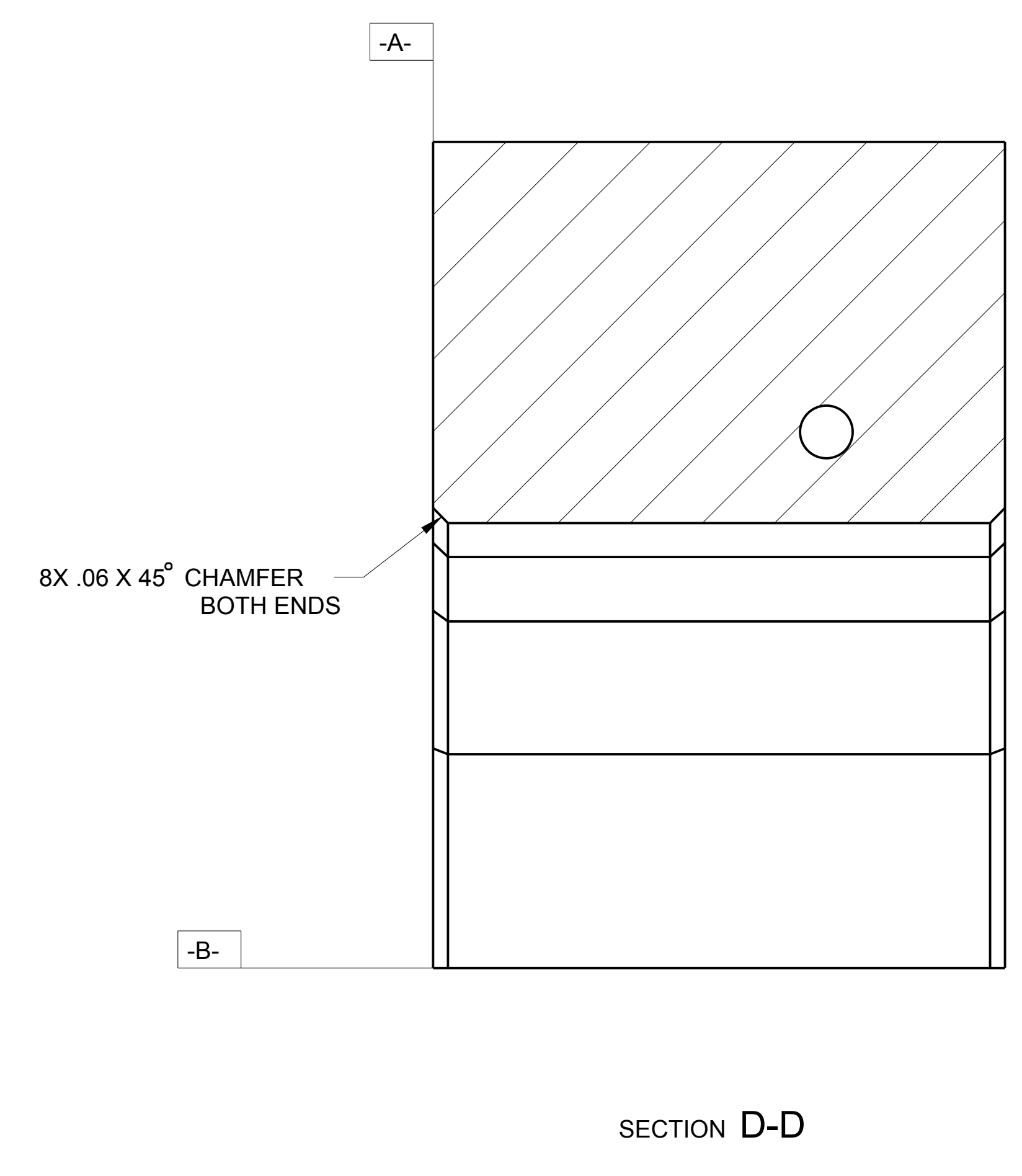

DETAIL C
SCALE: 2/1

⊕ ∅.002 A B C

POINT CHART		
POINT NAME	X	Y
PT01	-2.556	0.000
PT02	-2.362	0.978
PT03	-2.168	0.898
PT04	-1.659	1.659
PT05	-1.455	1.455
PT06	-0.788	1.902
PT07	-0.715	1.726
PT08	0.000	1.868
PT09	0.715	1.726
PT10	0.788	1.902
PT11	1.455	1.455
PT12	1.659	1.659
PT13	2.168	0.898
PT14	2.362	0.978
PT15	2.556	0.000

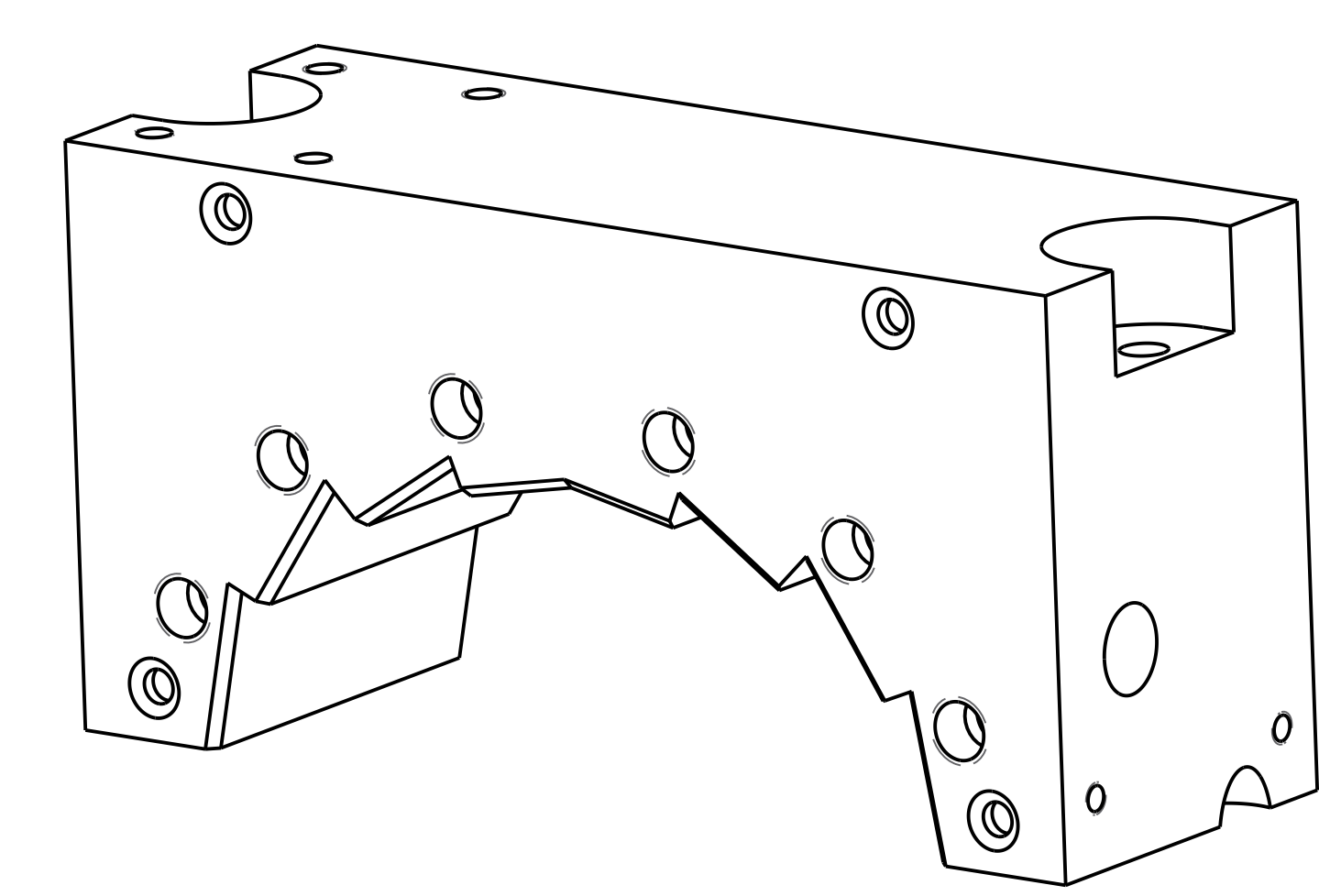

ISOMETRIC VIEW
FOR REFERENCE ONLY

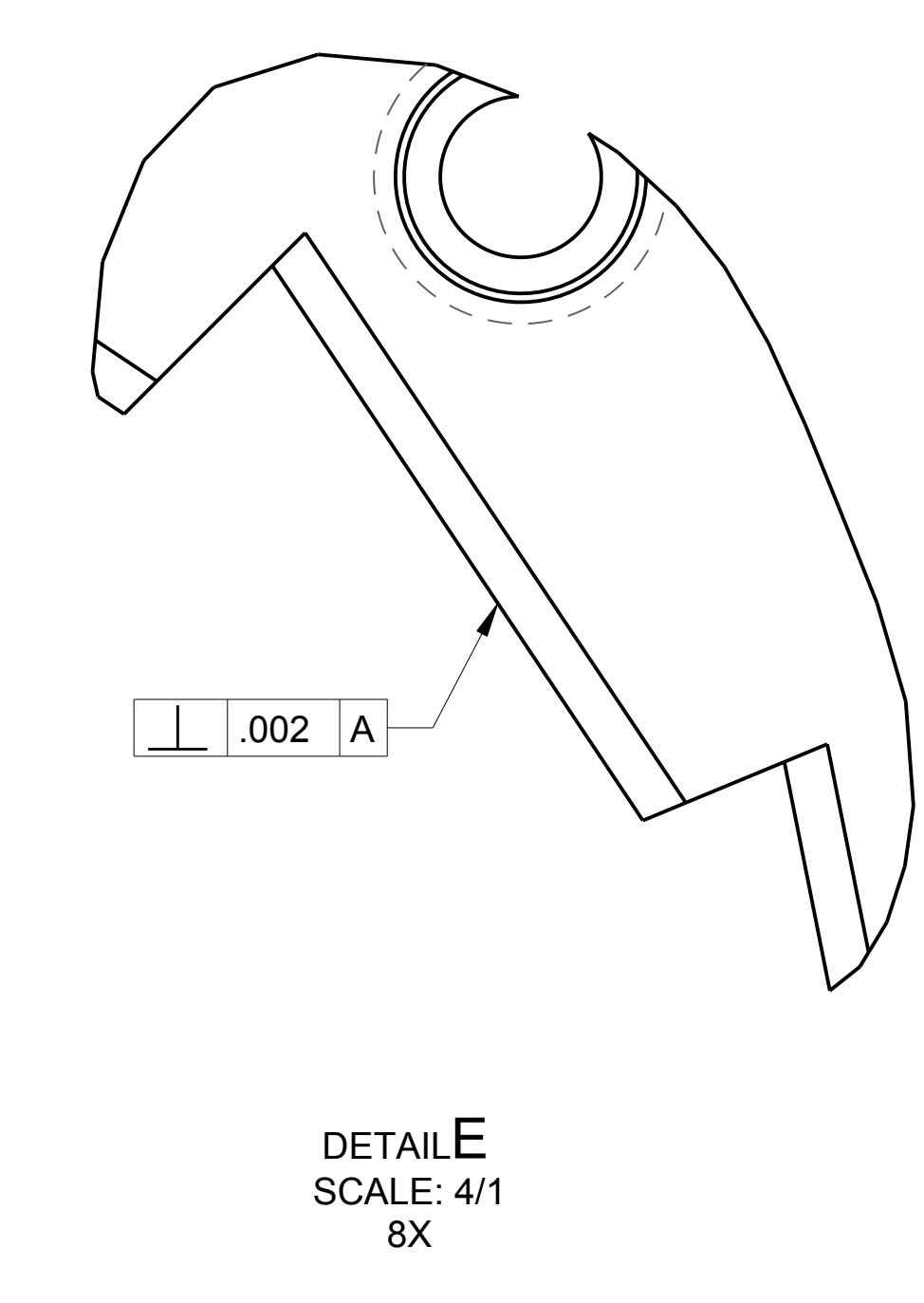

DETAIL E
SCALE: 4/1
8X