

NOTES:

1. MATERIAL: STAINLESS STEEL SHEET TYPE 304 PER ASTM A240
2. VIBRO-ETCH PART WITH DRAWING NUMBER WITH MIN .12 HIGH CHARACTERS IN ACCORDANCE WITH MIL-STD-130, LOCATE APPROX AS SHOWN.

REVISION APPROVALS								
REV	ECN NO.	DESCRIPTION	DATE	BY	CHK	DES	ENG	SUPV
A	-	INITIAL RELEASE	-	-	-	-	-	-

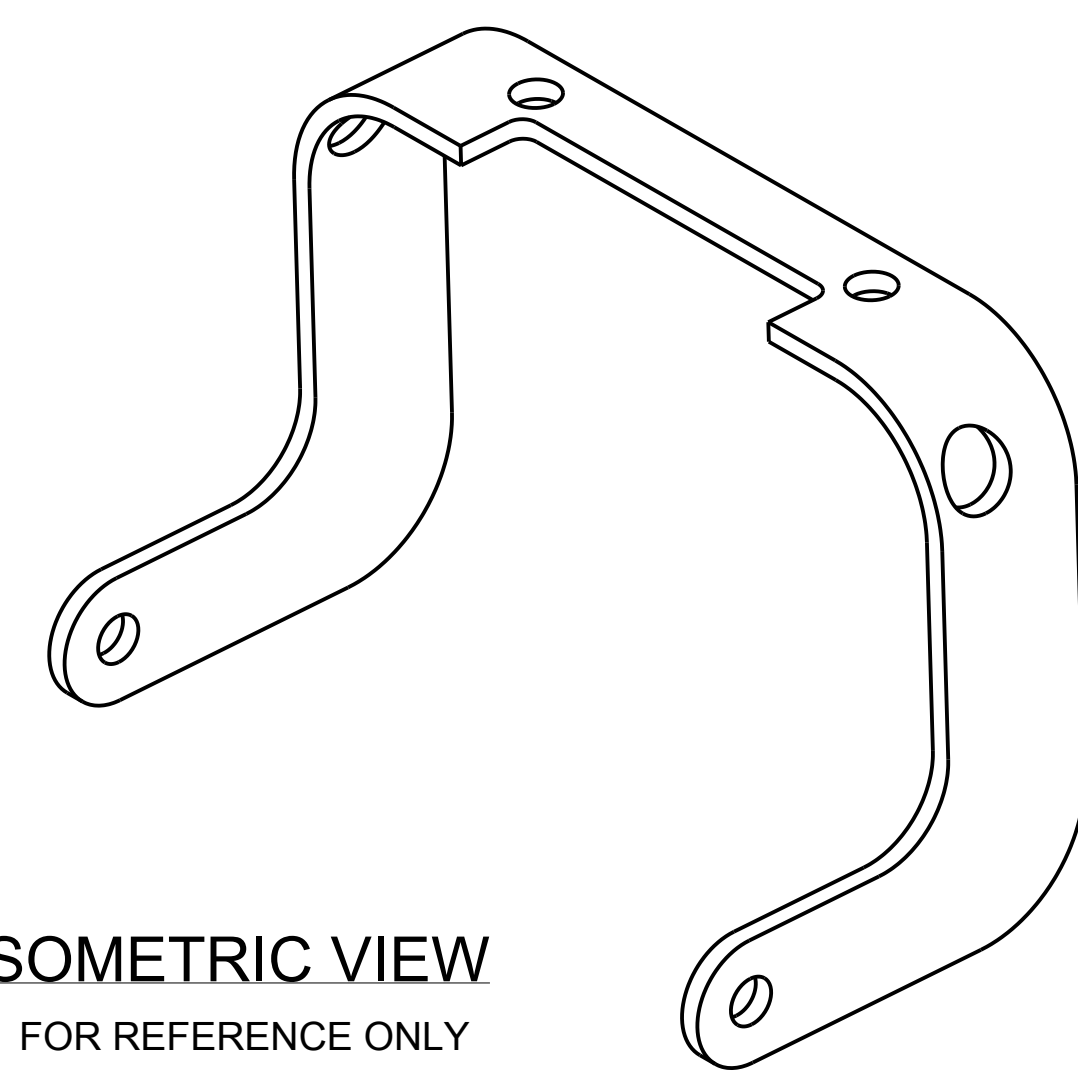
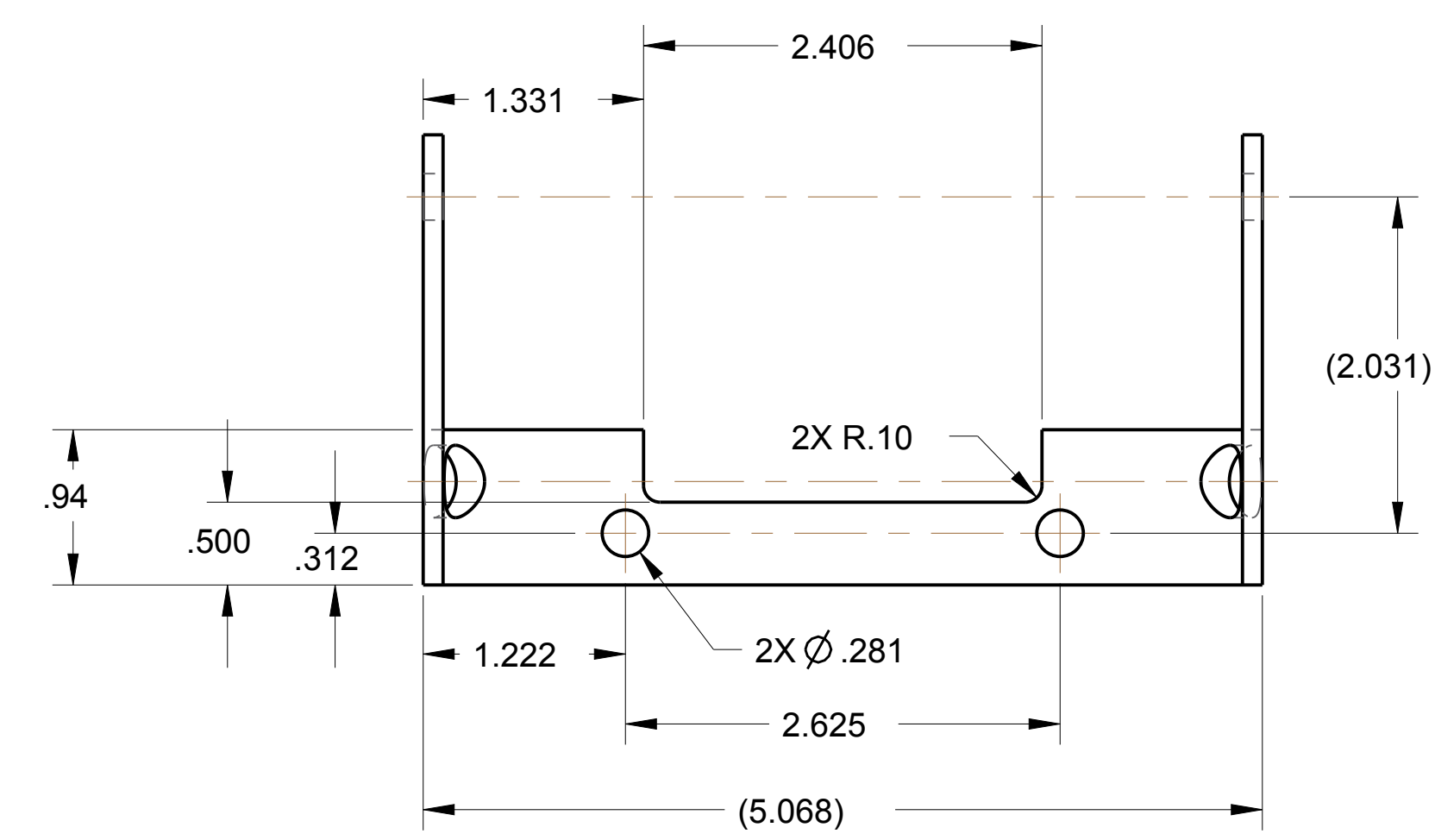
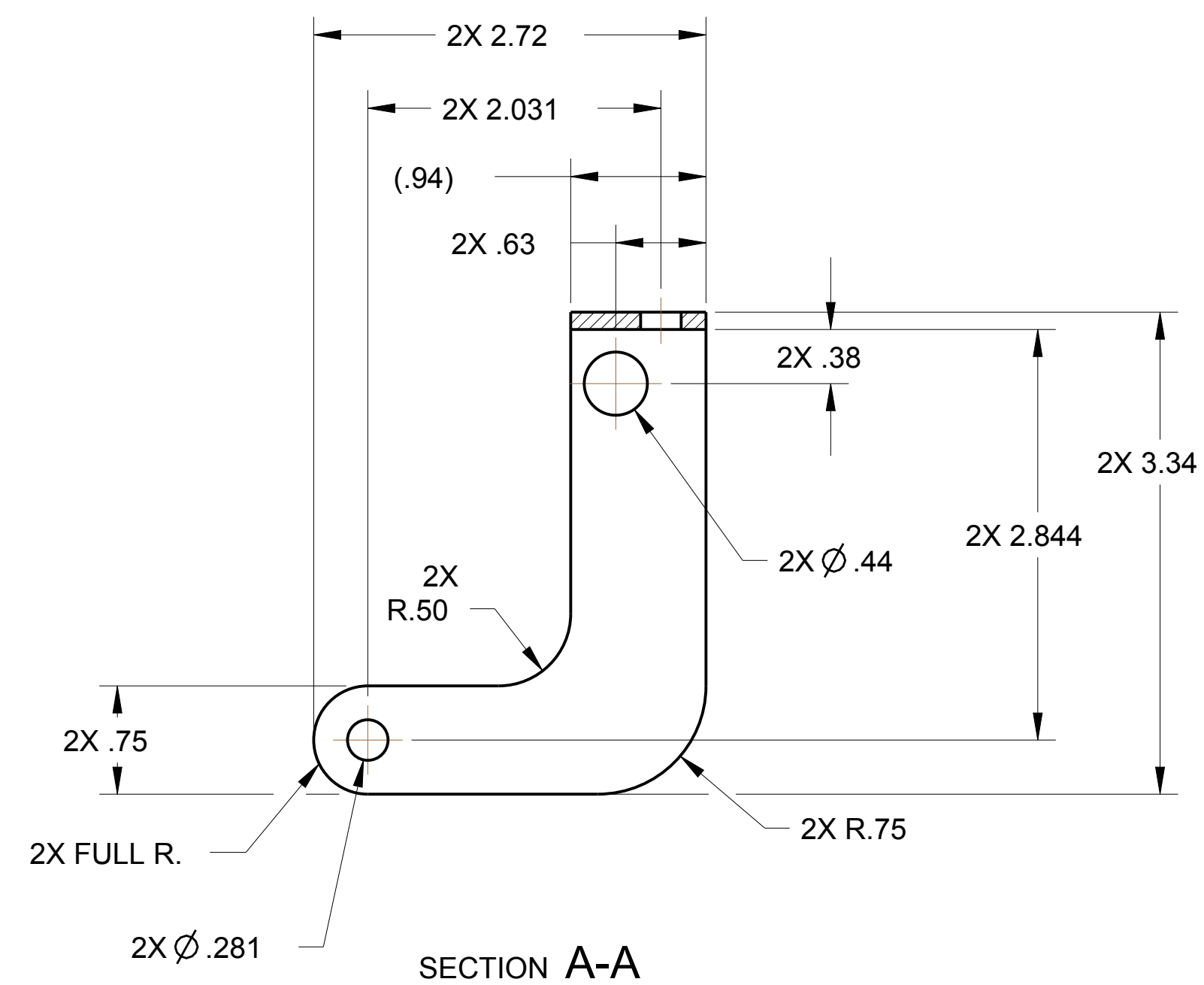
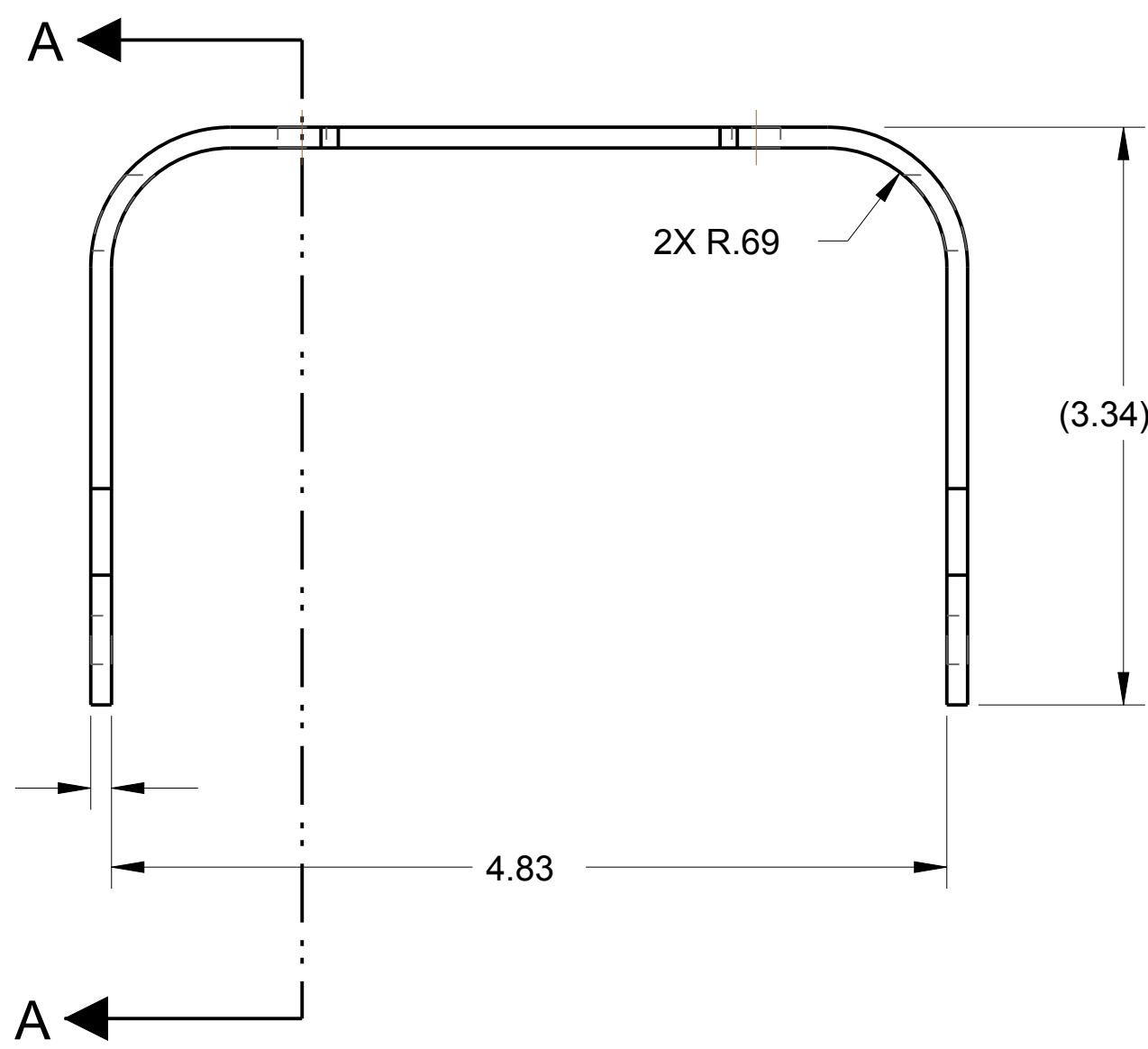
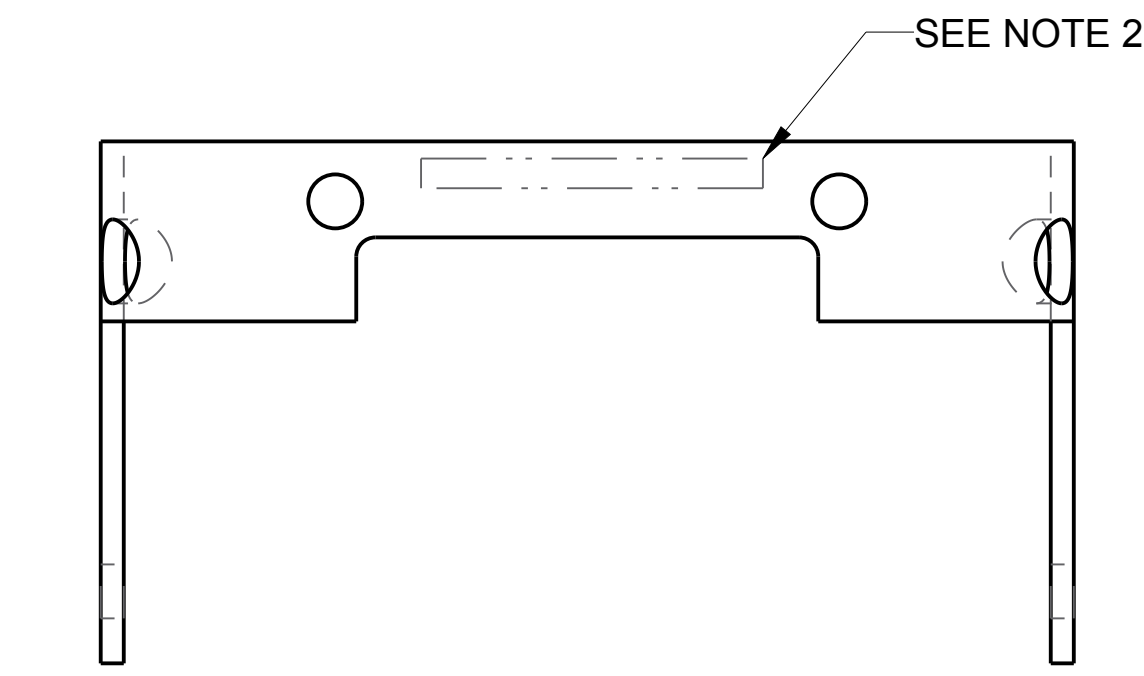

		INTERPRET IN GENERAL ACCORDANCE WITH ASME Y14.5				COLLIDER-ACCELERATOR DEPARTMENT BROOKHAVEN NATIONAL LABORATORY UPTON, N.Y. 11973		
		UNLESS OTHERWISE SPECIFIED		DRAWN BY: S. TRABOCCHI 08/24/17 CHECKED BY: S. RESTMEYER 3/19/18 DESIGN APPROVAL: A. ARNO 3/20/18 ENG / PRTY APPROVAL: G. MAHLER 3/20/18 SUPERVISOR APPROVAL: J. TUOZZOLO 3/20/18		CBETA MAGNET ASSEMBLY BRACKET, MAGNET SUPPORT, TYPE 1		
		DIMENSIONS ARE IN INCHES		CEE / CME DIVISION HEAD QA SAFETY / RSC DEPARTMENT CHAIR		SIZE: D DRAWING NUMBER: 2550M0073		REV. A
		DECIMAL TOLERANCES X± .030 XX± .015 XXX± .005		USED ON DRAWING NO. 125 QTY. PER ASSY. 2 APPLICATION: FINISH		Q.A. CATEGORY: A3 SCALE: 1/1 WEIGHT: 0.3 SHEET OF 1 1		CREO
		ANGULAR TOLERANCE ±1°		BREAK SHARP EDGES MAX. .001 IN. 015				

DWG NO. 2550M0073 SHIT 1 OF 1